

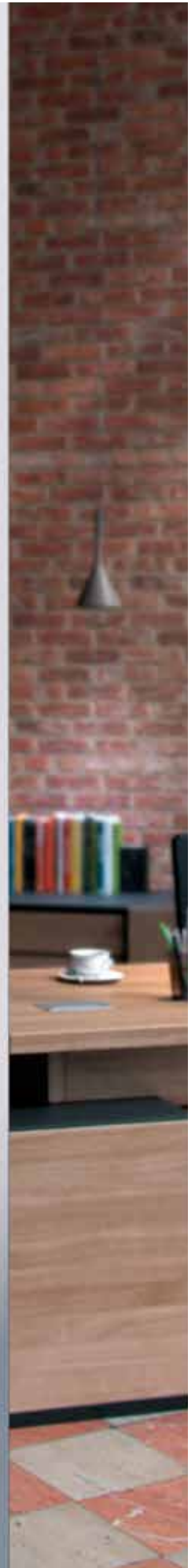

ANSELMI

The concealed hinge system
for residential doors



ANSELMI

The concealed hinge system for residential doors



Black
(AN 018)



Satin Chrome
(AN 014)



Polished Chrome
(AN 039)



Polished Brass
(AN 037)



Antique Bronze
(AN 035)



**RAL 9016
Traffic White**
(AN 049)

The extensive range of ANSELMI hinges offers high quality products for light interior doors. These concealed hinge systems are suitable for interior residential doors as well as for internal doors up to 60 kg and are available in several model versions. The hinge systems have three-dimensional adjustment and guarantee a long lasting, maintenance-free operation of the door and are available in 6 aesthetical finishes.

The ANSELMI patterns AN 150 3D and AN 170 3D offer the specifier the opportunity to use narrow frames of just 25 mm depth due to the reduced frame cup of the hinge, this offers the potential of concealed hinges in the most delicate of joinery details.

For those manufacturers searching for production economies of scale and easy installation of their products on-site, the ANSELMI hinges with a reduced hinge frame part are the best choice. They allow the installation of frame architrave without any additional operation onsite, while the central milling on the door panel offers a complete reversibility of the door, that can be used indistinctly for left and right as well as for inward and outward opening. Furthermore, the extensive programme allows to switch between the different hinge models, increasing the load capacity whilst keeping the same milling geometry.

The ANSELMI self closing hinges allow the closing of a door in an independent manner. The hinge with the integrated closing function is installed in the centre between the upper and lower hinge and has a special rotation system that makes it usable in combination with AN 160 3D. The installation on the door and frame differs from that of the hinges only in the depth of the milling on the door that is necessary to insert the spring – once the spring is inserted, the system is aesthetically identical to the hinges. The closing power can be adjusted when the door is installed.



ANSELMI

AN 150 3D

for unrebated residential doors with 21 mm reduced hinge frame part up to 40 kg

hinge | **21 mm hinge frame part** | **up to 40 kg**

Product features

- reduced hinge frame part 21 mm
- completely concealed hinge system
- for timber and aluminium frames
- for unrebated residential doors
- 3D adjustable (side +/- 1.5 mm, height +/- 2.5 mm, compression +/- 1.0 mm)
- material zamak / acetal

Technical details

load capacity	i 2 hinges per door leaf (900x2100 mm)	40.0 kg
overall length		110.0 mm
width (frame)		24.0 mm
width (door)		24.0 mm
cutter diameter		14.0 or 16.0 mm
collar ring diameter		25.0 or 27.0 mm
opening angle		180°

Finish

Satin Chrome (AN 014), Black (AN 018), Antique Bronze (AN 035), Polished Brass (AN 037), Polished Chrome (AN 039), RAL 9016 Traffic White (AN 049)

Note

i The load capacity mentioned above refers to the use of 2 hinges per door leaf (900 x 2100 mm).

Suggested screws:

Frame side: Countersunk head screws DIN 7505 A, Diameter 4.5 mm

Door side: Pan head screws DIN 7505 B, Diameter 4.5 mm

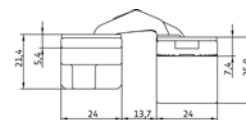
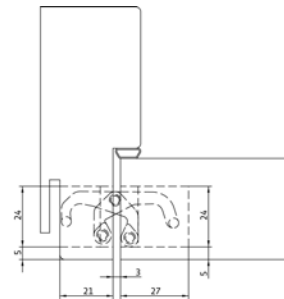
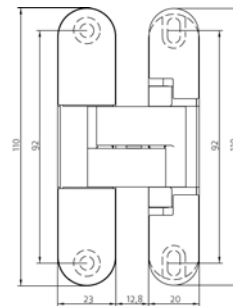

ANSELMI

AN 170 3D

for unrebated residential doors with 21 mm reduced hinge frame part up to 60 kg

hinge	21 mm hinge frame part	up to 60 kg
--------------	-------------------------------	--------------------

Product features

- reduced hinge frame part 21 mm
- completely concealed hinge system
- for timber and aluminium frames
- for unrebated residential doors
- 3D adjustable (side +/- 1.5 mm, height +/- 2.5 mm, compression +/- 1.0 mm)
- material zamak

Technical details

load capacity	i 2 hinges per door leaf (900x2100 mm)	60.0 kg
overall length		110.0 mm
width (frame)		24.0 mm
width (door)		24.0 mm
cutter diameter		14.0 or 16.0 mm
collar ring diameter		25.0 or 27.0 mm
opening angle		180°

Finish

Satin Chrome (AN 014), Black (AN 018), Antique Bronze (AN 035), Polished Brass (AN 037), Polished Chrome (AN 039), RAL 9016 Traffic White (AN 049)

Note

i The load capacity mentioned above refers to the use of 2 hinges per door leaf (900 x 2100 mm).

Suggested screws:

Frame side: Countersunk head screws DIN 7505 A, Diameter 4.5 mm

Door side: Pan head screws DIN 7505 B, Diameter 4.5 mm

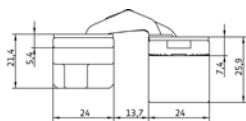
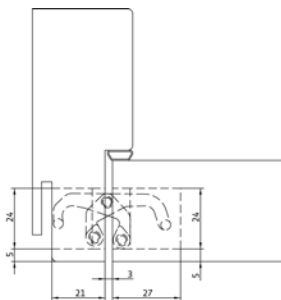
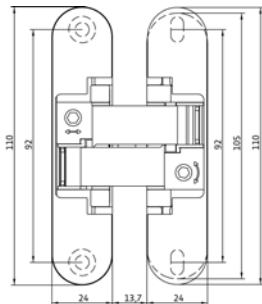

ANSELMI

AN 160 3D

for unrebated residential doors up to 60 kg

hinge

up to 60 kg

Product features

- completely concealed hinge system
- for timber and aluminium frames
- for unrebated residential doors
- 3D adjustable (side +/- 1.5 mm, height +/- 2.5 mm, compression +/- 1.0 mm)
- material zamak

Technical details

load capacity	 2 hinges per door leaf (900x2100 mm)	60.0 kg
overall length		110.0 mm
width (frame)		24.0 mm
width (door)		24.0 mm
cutter diameter		14.0 or 16.0 mm
collar ring diameter		25.0 or 27.0 mm
opening angle		180°

Finish

Satin Chrome (AN 014), Black (AN 018), Antique Bronze (AN 035), Polished Brass (AN 037), Polished Chrome (AN 039), RAL 9016 Traffic White (AN 049)

Note

 The load capacity mentioned above refers to the use of 2 hinges per door leaf (900 x 2100 mm).

Suggested screws:

Frame side: Countersunk head screws DIN 7505 A, Diameter 4.5 mm

Door side: Pan head screws DIN 7505 B, Diameter 4.5 mm

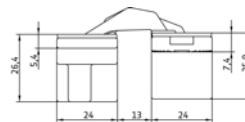
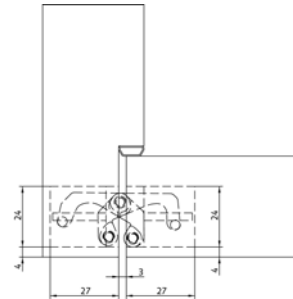
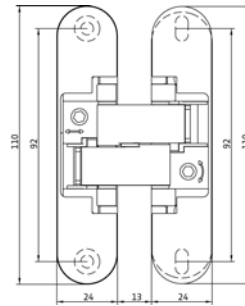

ANSELMI

AN 107 3D C

with integrated self closing function for unrebated residential doors

hinge	unrebated	up to 60 kg
-------	-----------	-------------

Product features

- self closing hinge system
- AN 107 3D C40 – closing power from 20 kg up to 40 kg
- AN 107 3D C60 – closing power from 40 kg up to 60 kg
- completely concealed hinge system
- for timber frames
- for unrebated residential doors
- adjustable closing power when door is installed
- material zamak /steel

Technical details

overall length	i 2 hinges per door leaf (900x2100 mm)	110.0 mm
width (frame part)		24.0 mm
width (door part)		24.0 mm
cutter diameter		14.0 or 16.0
collar ring diameter		25.0 or 27.0
opening angle		180°

Finish

Satin Chrome (AN 014), Black (AN 018), Antique Bronze (AN 035), Polished Brass (AN 037), Polished Chrome (AN 039), RAL 9016 Traffic White (AN 049)

Combination

hinge	AN 160 3D
-------	-----------

Note

i The closing power mentioned above refers to the use of one self closing hinge per door leaf (900 x 2100 mm).
 The self closing hinge has to be used only in combination with the given hinges and has to be installed at half the height of the door leaf, approximately at the same height of the lock (magnetic lock recommended).
 The installation on doors subject to specific norms has to be verified by the customer according to the national law.

Model variants

closing power from 20 kg up to 40 kg	blue spring	AN 107 3D C40
closing power from 40 kg up to 60 kg	red spring	AN 107 3D C60

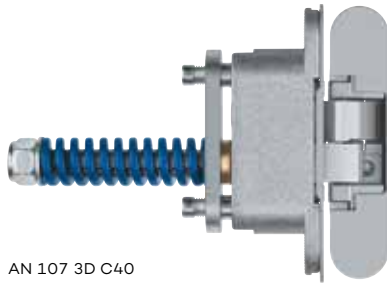

AN 107 3D C40

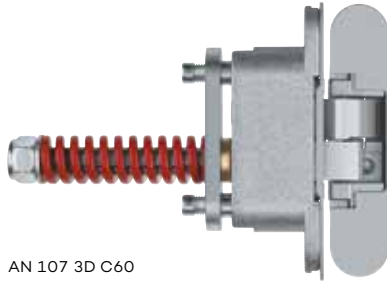

AN 107 3D C60

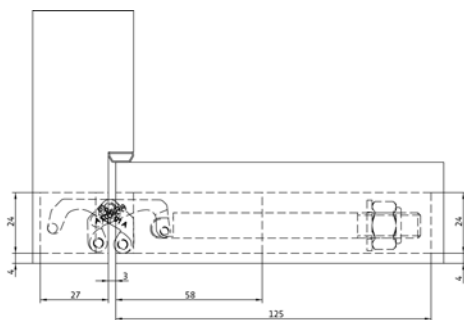
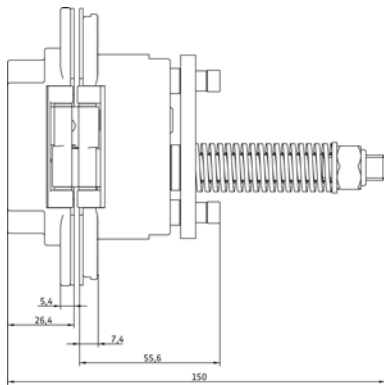

SIMONSWERK

SIMONSWERK UK Ltd

Burcot Works, Spring Street
Tipton, West Midland DY4 8TF
United Kingdom

☎ +44 121 5222848

✉ info@simonswerk.co.uk

www.simonswerk.co.uk

Member of the
**SIMONSWERK
GROUP**